

Box for grounding connector

Box for grounding connector

made from material ABS are characterized by high functionality and possibilities of adaptation for users needs. Box is designated for flush mounting of control connector for grounding installations. Box themselves are built from two main elements, joined together. Construction of the box allows the sliding, giving in results smooth adjustment of height, so adapting to different thickness of wall is possible. This advantage is especially useful in case of wall with thermal insulations. Mounting box is possible even in walls with 15 cm thick insulations. Third component is cover made from polystyrene. Closed with steel screws cover efficiently protect connector from unauthorized access, and accidental contacts with connector. Material of cover are protected against UV radiations, so that is possible to safely install it on sunny walls. Modular design of box allows quick and fast assembly, even in unusually position. Mounted box ensures very efficient protection of control connector from weather condition.



Advantages of box for grounding connector

- » Cover resistant to UV radiation
- » Efficient protection of control connector from weather condition
- » Simple installation of control connector
- » Excellent solutions for installations in walls, even 15 cm thick insulations, thanks to smooth adjustment of depth
- » Simple design for ease of assembly

Box for grounding connector



R.8145



R.8145S



210 mm



165 mm



80-150 mm



1

Depth regulation range:
R.8145/R.8145S: 82-150mm

Box for grounding connector - dimension

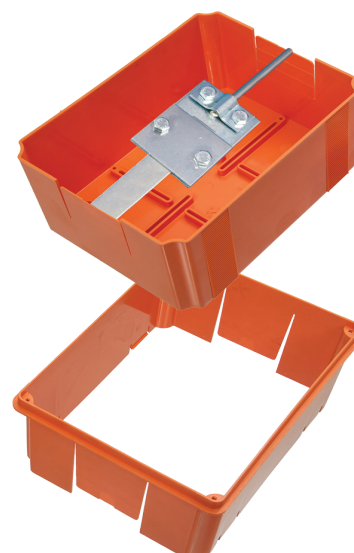
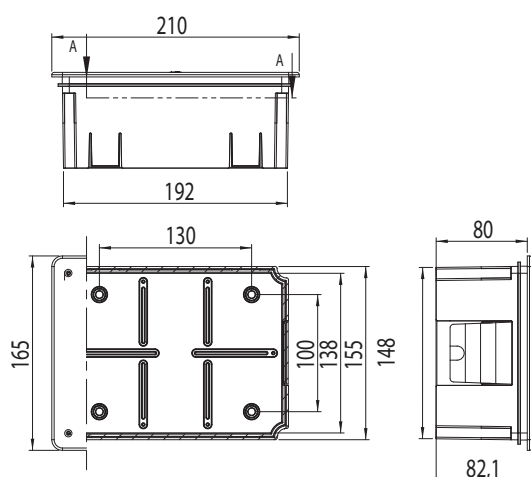

Box for grounding connector

Box for grounding connector made from material ABS are characterized by high functionality and possibilities of adaptation for users needs. Box is designated for flush mounting of control connector for grounding installations. Box themselves are build from two main elements, joined together. Construction of the box allows the sliding, giving in results smooth adjustment of height, so adapting to different thickness of wall is possible. This advantage is especially useful in case of wall with thermal insulations. Mounting box is possible even in walls with 14,5 cm thick insulations. Third component is cover made from polystyrene. Closed with steel screws cover efficiently protect connector from unauthorized access, and accidental contacts with connector. Material of cover are protected against UV radiations, so that is possible to safely install it on sunny walls. Modular design of box allows quick and fast assembly, even in unusually position. Mounted box ensures very efficient protection of control connector from weather condition.

Box for grounding connector



 R.8144

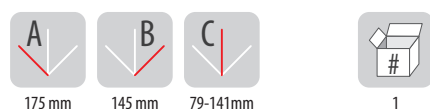

Box for grounding connector with door



 R.8144D

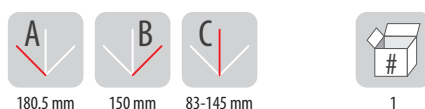

The advantages of the new solution are:

- Possibility of installing after or before thermo-modernization of the building
- Aesthetic and comfortable installation of the control connector
- Regulation of the box depth in range 83-145 mm,
- Covers resistant to UV radiation



The new box has a lot of new functions – not only the protection and aesthetic installation of the grounding connector! Now, you can also use it, for example, for additional protection and installation of BETA sockets. Note – the BETA socket is shown only for demonstration purposes

Depth regulation range: R.8144: 79-141mm

Box for grounding connector - dimension

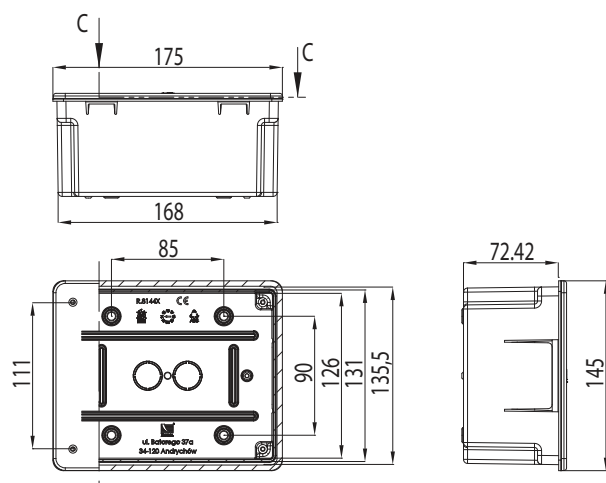

Depth regulation range: R.8144D: 83-145mm

Box for grounding connector with door - dimension

